

CURVA A 45° CON CODOLO LISCIO - ISO 8434-1 (DIN 2353) 45° ELBOW STANDPIPE - ISO 8434-1 (DIN 2353)

Serie L/S

L/S Series

Codice/Code: 7015..

Tipo/Type: BEL45/BES45

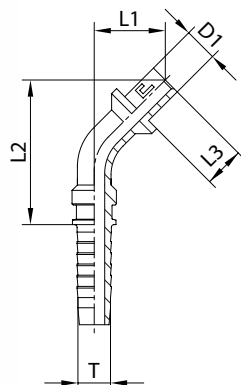

CODICE Code	Ø interno tubo T I.D. hose			Ø codolo standpipe Ø D1	L1	L2	L3	PN WP [bar]
	DN	size	INCH					
701501	5	-3	3/16	6L/S	23	48	19	415
701502	5	-3	3/16	8L/S	23,5	48,5	22,5	415
701503	6	-4	1/4	6L/S	23	48	19	450
701504	6	-4	1/4	8L/S	23,5	48,5	22,5	450
701505	6	-4	1/4	10L/S	22,5	47,5	21,5	450
701506	6	-4	1/4	12L/S	26	51	25,5	450
701507	8	-5	5/16	10L/S	25,5	55,5	21,5	350
701508	8	-5	5/16	12L/S	28,5	58,5	25,5	350
701509	10	-6	3/8	10L/S	27,5	62	21,5	445
701510	10	-6	3/8	12L/S	30,5	64,5	25,5	445
701511	10	-6	3/8	14S	29	63,5	23,5	445
701512	10	-6	3/8	15L	28,5	63	23	315
701513	12	-8	1/2	14S	30,5	73	23,5	415
701514	12	-8	1/2	15L	30	72,5	23	315
701515	12	-8	1/2	16S	30,5	73	24	400
701516	12	-8	1/2	18L	29	71,5	21,5	315
701517	16	-10	5/8	18L	30	78,5	21,5	315
701518	16	-10	5/8	20S	35	83	28	350
701519	19	-12	3/4	20S	39,5	96	28	350
701520	19	-12	3/4	22L	35,5	92	22,5	160
701521	19	-12	3/4	25S	41,5	98	31	350
701522	25	-16	1	25S	42,5	120	31	280
701523	25	-16	1	28L	37,5	115	24	160
701524	25	-16	1	30S	44,5	122	34	280
701525	31	-20	1 1/4	35L	48,5	140,5	30,5	160
701526	31	-20	1 1/4	38S	55	147,5	40	210
701527	38	-24	1 1/2	38S	60,5	180,5	40	185
701528	38	-24	1 1/2	42L	55,5	175	32,5	160

NOTE: Desiderando ordinare il raccordo in acciaio inox, sostituire nel codice il 70.. iniziale con 71..
 NOTE: If you wish to order a fitting in stainless steel, please change the first two digit from 70.. to 71..