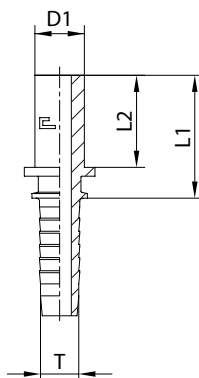

Serie L/S

L/S Series

**Codice/Code:** 7013..

**Tipo/Type:** BEL/BES

CODICE Code	Ø interno tubo T I.D. hose			Ø codolo standpipe Ø D1	L1	L2	PN W/P [bar]
	DN	size	INCH				
701301	5	-3	3/16	6L/S	26	19	415
701302	5	-3	3/16	8L/S	29,5	22,5	415
701303	6	-4	1/4	6L/S	26	19	450
701304	6	-4	1/4	8L/S	29,5	22,5	450
701305	6	-4	1/4	10L/S	28,5	21,5	450
701306	6	-4	1/4	12L/S	32,5	25,5	450
701307	8	-5	5/16	10L/S	29	21,5	350
701308	8	-5	5/16	12L/S	33	25,5	350
701309	10	-6	3/8	10L/S	29	21,5	445
701310	10	-6	3/8	12L/S	33	25,5	445
701311	10	-6	3/8	14S	31	23,5	445
701312	10	-6	3/8	15L	30,5	23	315
701313	12	-8	1/2	14S	31,5	23,5	415
701314	12	-8	1/2	15L	31	23	315
701315	12	-8	1/2	16S	32	24	400
701316	12	-8	1/2	18L	29,5	21,5	315
701317	16	-10	5/8	18L	29,5	21,5	315
701318	16	-10	5/8	20S	36	28	350
701319	19	-12	3/4	20S	36,5	28	350
701320	19	-12	3/4	22L	31	22,5	160
701321	19	-12	3/4	25S	39,5	31	350
701322	25	-16	1	25S	41,5	31	280
701323	25	-16	1	28L	34,5	24	160
701324	25	-16	1	30S	44,5	34	280
701325	31	-20	1 1/4	35L	41,5	30,5	160
701326	31	-20	1 1/4	38S	51	40	210
701327	38	-24	1 1/2	38S	52	40	185
701328	38	-24	1 1/2	42L	44,5	32,5	160

**NOTE:** Desiderando ordinare il raccordo in acciaio inox, sostituire nel codice il 70.. iniziale con 71..  
**NOTE:** If you wish to order a fitting in stainless steel, please change the first two digit from 70.. to 71..